

**S-TYPE**

DATE 7/99

S307-02

SERVICE**TECHNICAL BULLETIN****Stuck Ignition Key –
Modify J-Gate Interlock Lever –
Service Action S114**MODEL 2000 MY-ON
S-TYPE

VIN L00600-L11869

Issue:

Some 2000 MY S-TYPE vehicles within the above VIN range may, under high temperature conditions, experience a malfunction of the J-Gate interlock mechanism which results in the inability to remove the ignition key when the gear selector lever is placed in 'Park'.

This bulletin provides a procedure to install an e-clip on the pivot bolt to increase the clearance of the pivot of the interlock lever.

Action:

Check if the service action has already been performed on the vehicle by performing a DCS claim search. If the service action has not yet been performed, modify the interlock lever of all 2000 MY S-TYPE vehicles within the above VIN range before sale or at the first service opportunity. Install the e-clip using the procedure outlined in this bulletin.

MODIFYING PIVOT BOLT OF INTERLOCK LEVER

1. Fully apply the parking brake. Release the snap fastener of the boot on the parking brake lever.
2. Lift up the lid of the center console.
3. Move the gear shift selector lever to 'Neutral'.
4. Raise the upper console. (Clips may become detached - there is a total of 7 clips).
5. Reach under the console to detach the electrical connectors for the Traction Control Switch, Sports/Normal mode switch, cigar lighter and phone connections, where applicable.

J-GATE INTERLOCK MECHANISM (S-TYPE)

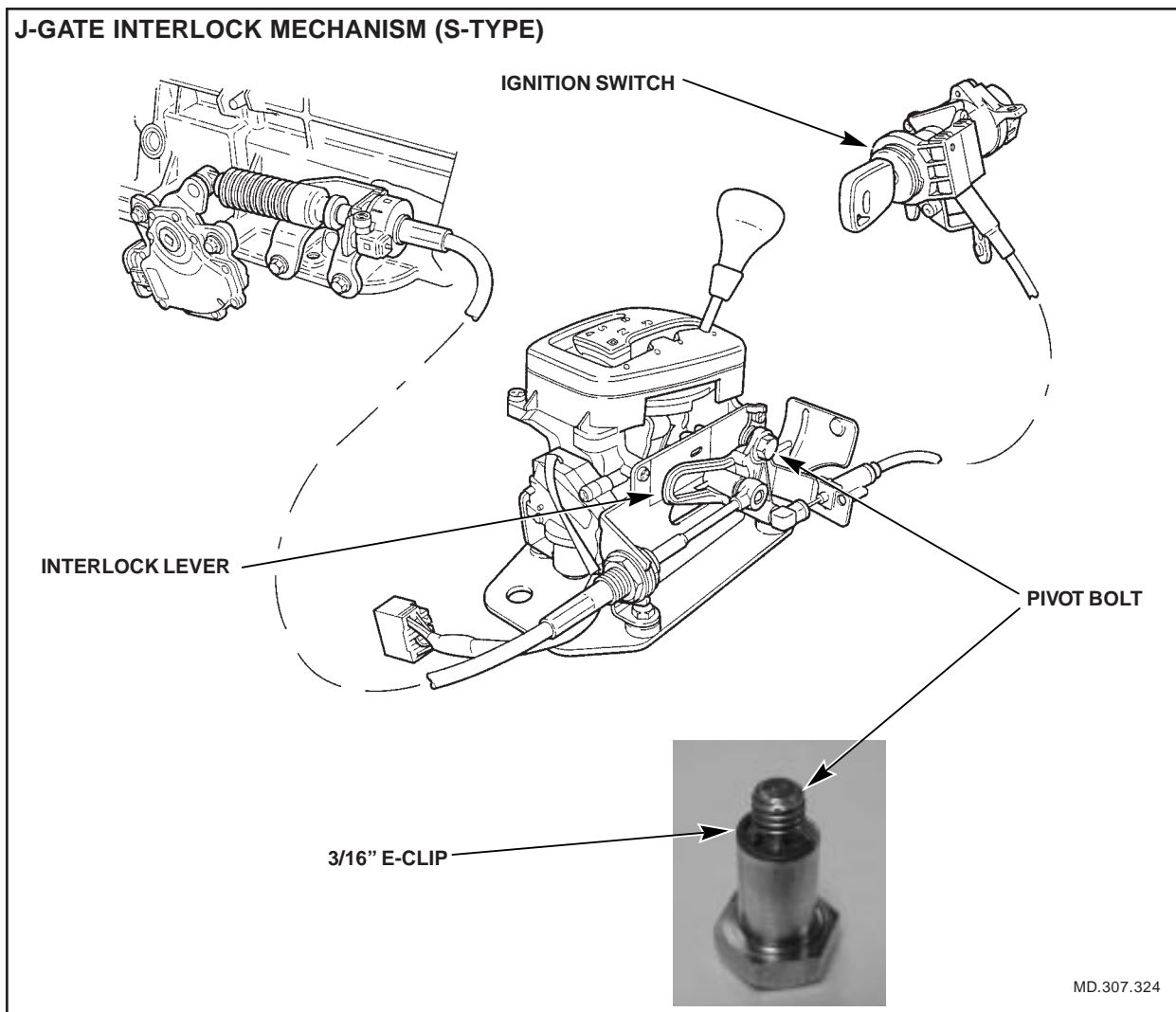

ILLUSTRATION 1

6. On the right side of the J-gate assembly, remove the pivot bolt that retains the interlock lever (Illustration 1).
7. Check for any excess thread locking compound on the interlock lever. Wipe off any excess.
8. Install a 3/16 inch e-clip on to the bolt (Illustration 1), **ensuring that the e-clip does not extend beyond the shank of the bolt. Make sure that the bolt turns freely in the lever.** If necessary, use a reamer to bevel the opening of the lever.
9. Reinstall the bolt. Do not use thread locking compound.
10. Ensure that the interlock lever moves freely and that the key can be easily removed when the range selector lever is in 'Park'.
11. Reassemble the console components in the vehicle.

Parts Information:

<u>DESCRIPTION</u>	<u>PART NUMBER</u>	<u>QTY</u>
E-clip	JAG 000099	1

Warranty Information:

Service Action S114

<u>VEHICLE</u>	<u>SUMMARY CODE</u>	<u>DESCRIPTION</u>	<u>R.O. NUMBER</u>	<u>TIME ALLOWANCE</u>
S-TYPE 2000 MY VIN L00600-L11869 Model codes 6100, 6300, 6310	BX	Install e-clip on pivot shaft -without drive-in/out time (performed with another repair.)	44.91.23	0.25 hrs.
S-TYPE 2000 MY VIN L00600-L11869 Model codes 6100, 6300, 6310	BZ	Install e-clip on pivot shaft -with drive-in/out time (only repair performed)	44.91.23 10.10.10	0.25 hrs. 0.15 hrs.

NOTE: Always perform a DCS claim search first to determine whether this service action has been performed on this vehicle. The warranty selection under the vehicle inquiry will give a listing of all claims against the vehicle. If S114 appears in the fault code field, do not perform this service action.

CLAIM SUBMISSION PROCEDURE:

Warranty summary codes have been assigned to this service action in order to simplify claim submission. The dealership will be reimbursed the parts and labor time allowance as indicated.

DCS DEALERS

Submit claims using the appropriate summary code for the vehicle model and work performed. Follow standard campaign submission procedures.

NON-DCS DEALERS

Submit claims on the Recall Campaign Summary form W-25. Enter the appropriate summary code for the vehicle model and work performed in the Repair Code column. Do not use the W-1 warranty claim form.