

TECHNICAL BULLETIN



Hood Panel – Difficult to Latch/Contacts Plenum Grille – Reprofile Hood

76-109

MODEL XJS Range 1994-95 MY
VIN 190528 - 196254

DATE 9/95

ISSUE:

Some XJS Range vehicles within the above VIN range may exhibit hoods that are difficult to latch on both sides and/or contact the plenum chamber grille. Repeated pressing and slamming of the hood flattens the curvature of the hood causing contact with the grille. The flattening of the hood also causes the striker pins to move apart in relation to each other, make it more difficult to engage both latches.

ACTION:

In case of a customer complaint of difficulty in closing the hood on a vehicle within the above VIN range, **ensure that Service Action S448, (Bulletin 76-96 Date 11/94) has been performed on the vehicle** before proceeding.

If so, perform the following repair:

1. Remove and discard the rear bulkhead to hood seal, Illustration 1.

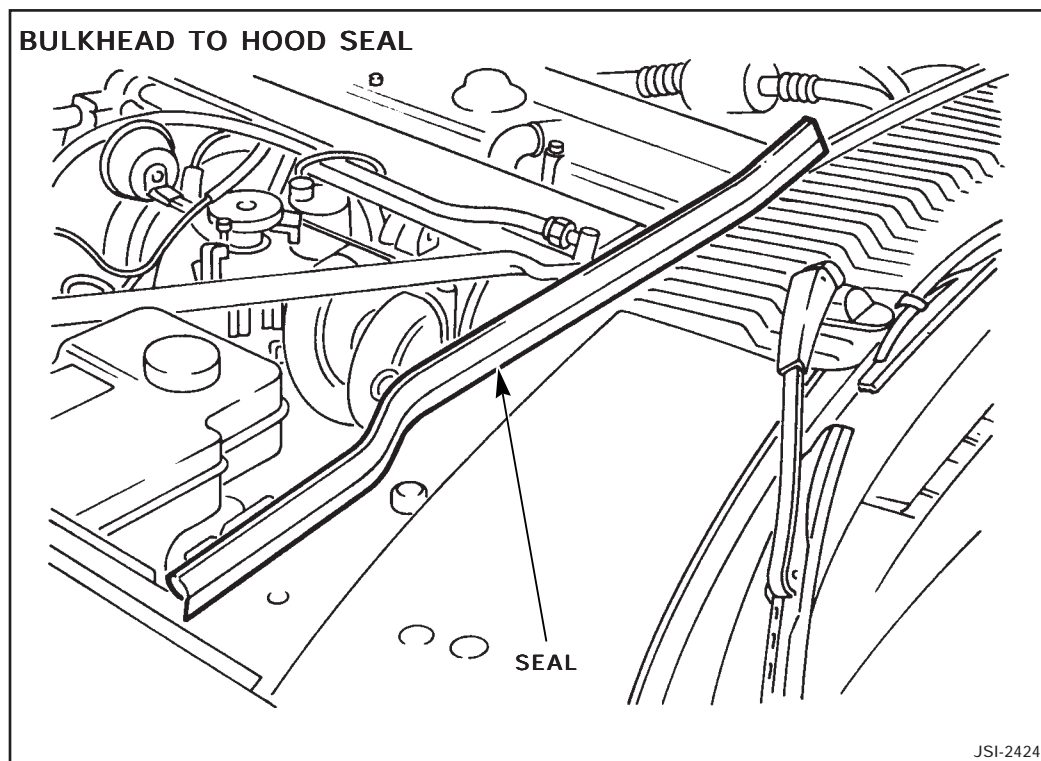

ILLUSTRATION 1

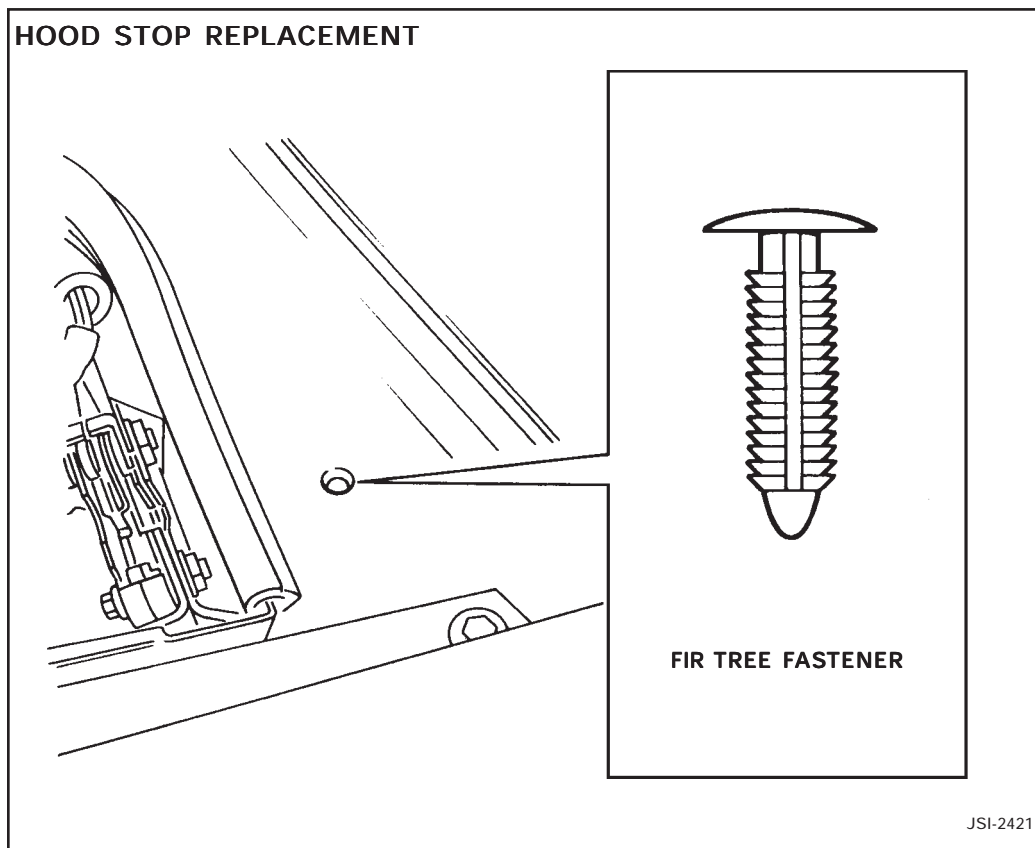

ILLUSTRATION 2

2. Remove and discard the hood stop buffers, mounting bolts, nuts, and washers. Apply a suitable sealer to the bolt holes and install fir tree fasteners, Illustration 2.
3. Cut two new hood seals to size and install on the engine compartment rear bulkhead ensuring that the joint of the seals is at the center line of the hood.

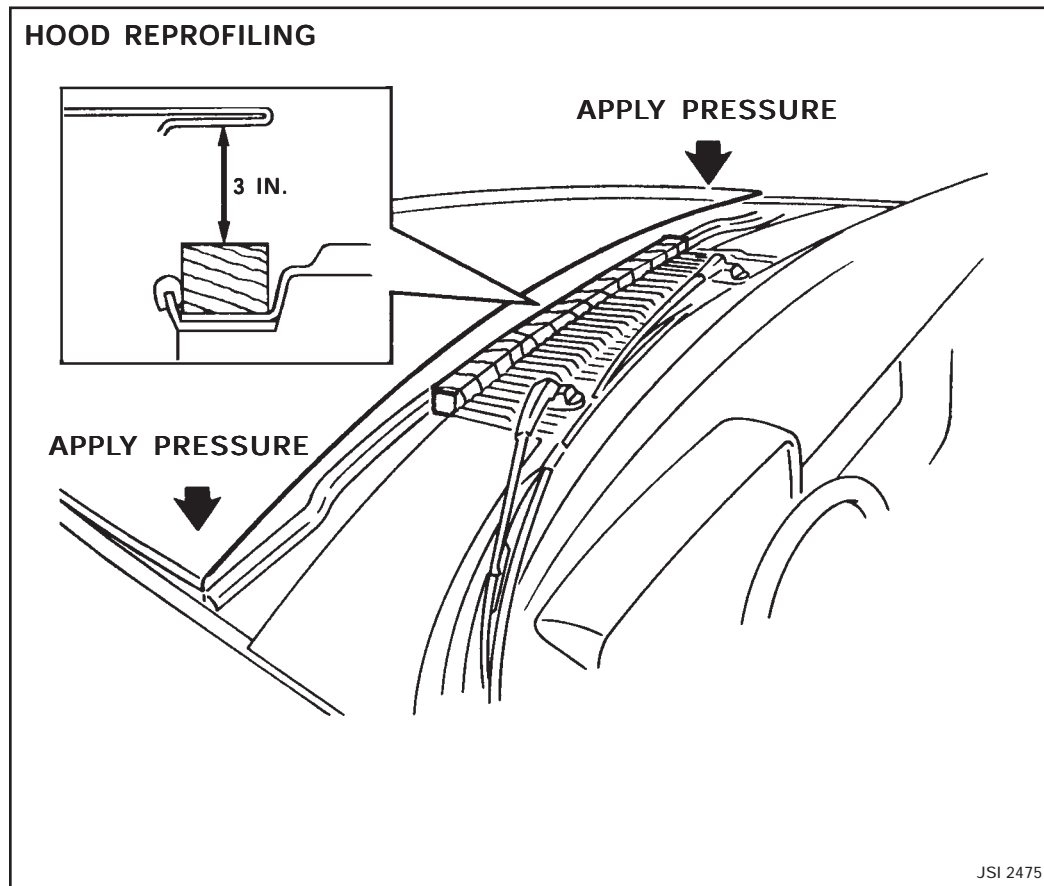

ILLUSTRATION 3

4. Obtain a suitable block of wood, Illustration 3, which will fit in the space between the bulkhead lip and the front edge of the plenum chamber. The block must be deep enough to rest on the drain channel and protrude above both edges. The block should be as long as the plenum grille to spread out the load.
5. Wrap the block with adhesive tape to prevent damage to the paint during the next operation.
6. Place the covered wooden block between the bulkhead and the plenum chamber on the car center line.
7. Insert a suitable smooth object which will not damage the paint or the panel, such as a rubber mallet, between the hood panel and the wooden block to support the hood at a height of approximately 3 in. (7.5 cm), Illustration 3.
8. Apply pressure to the areas over the striker pins, Illustration 3, to modify the hood curvature and raise the center of the hood panel in relation to the sides.

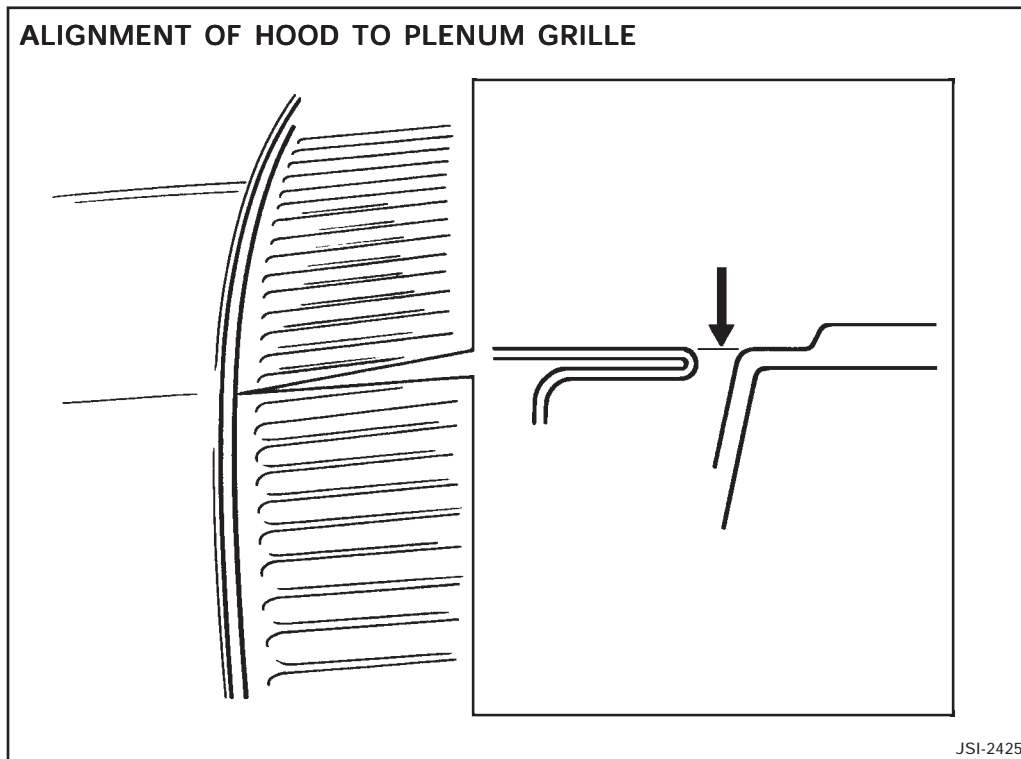

ILLUSTRATION 4

9. Check the fit of the hood to the body at the center, the plenum grille, (Illustration 4) and both outer edges.
10. Repeat the process until the hood profile matches the body profile.

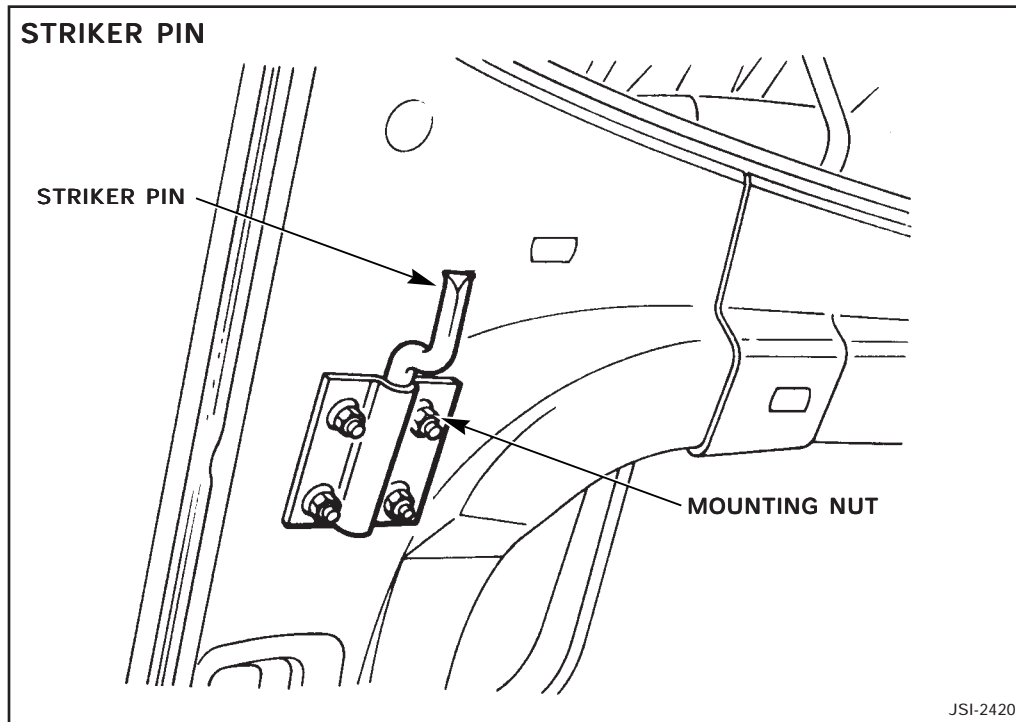

ILLUSTRATION 5

11. Loosen the nuts that secure the hood striker pins (Illustration 5) to allow some movement when the hood is closed.
12. Close the hood to check where the catches require adjustment.
13. Open the hood. Loosen the hood catch retaining bolts, reposition the catch assemblies and tighten the retaining bolts.
14. Check the hood position and tighten the striker pin mounting nuts.
15. Check striker and catch operation.

PARTS INFORMATION:

<u>DESCRIPTION</u>	<u>PART NUMBER</u>	<u>QTY</u>
Hood seal	HHC 5242AA	2
Fir tree fastener	BBC 7525LEG	2

WARRANTY INFORMATION:

<u>FAULT CODE</u>	<u>R.O. NUMBER</u>	<u>DESCRIPTION</u>	<u>TIME ALLOWANCE</u>
WB BC JC	76.92.73	Reprofile hood	0.60 hrs.