

TECHNICAL BULLETIN



Front Seat Belts – Too Short and/or Twisting – Repair Procedure

76-110

MODEL XJS Convertible 2+2 From 1994 MY DATE 10/95
VIN 188105 - 198711

ISSUE:

New front seat belt assemblies have been introduced in production on XJS 2+2 convertibles as of VIN 198712. These assemblies address customer complaints that the original seat belts were too short and/or became twisted. The new design prevents the belt from twisting and has a 200 mm longer belt.

ACTION:

In case of a customer complaint on XJS 2+2 Convertibles within the above VIN range, that the front seat belts are too short or become twisted, install the new style assemblies as follows:

1. Apply the hand brake, select Park or Neutral on automatic transmissions or neutral on manual transmissions, release the convertible top catches, turn the ignition to position II, and lower the convertible top.
2. Move both front seats into the fully forward position for better access. Turn the ignition off.
3. After removing the rear seat cushion securing nuts, reposition the seat belt buckles through the cushion and remove the cushion.
4. Remove the rear seat squab.
5. Remove the sill tread plate.
6. Remove the rear quarter trim assembly.
7. Disconnect the speaker and interior lamp connectors.
8. Reposition the carpet edge adjacent to the seat belt lower anchorage bar.
9. Slide the seat belt off the lower anchorage rail and through the opening in the trim assembly.
10. Remove the upper anchorage bolt and the retractor bolt. Remove the seat belt assembly.

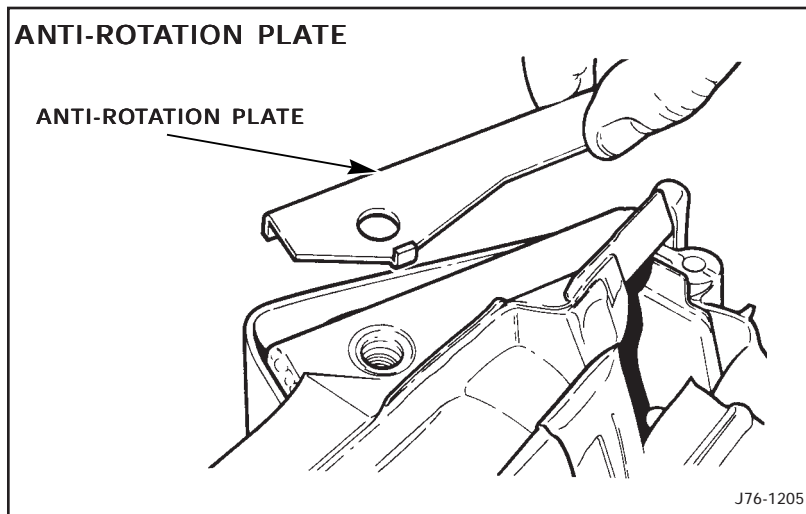

ILLUSTRATION 1

11. Remove and discard the anti-rotation plate from the top of the B post (Illustration 1).

NOTE: Do not install the anti-rotation plate with the new seat belt assembly.

12. Install the rub strip edge finisher into the opening in the B post and over the insulation (Illustration 2).

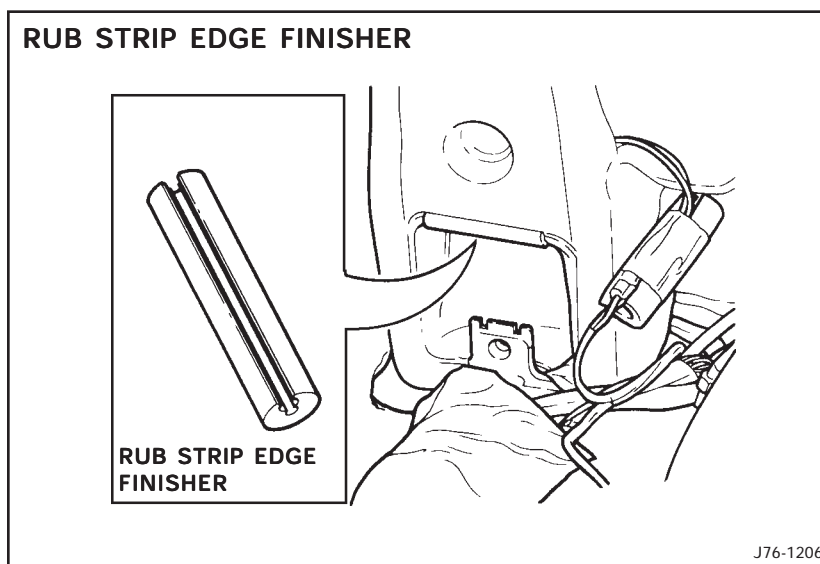

ILLUSTRATION 2

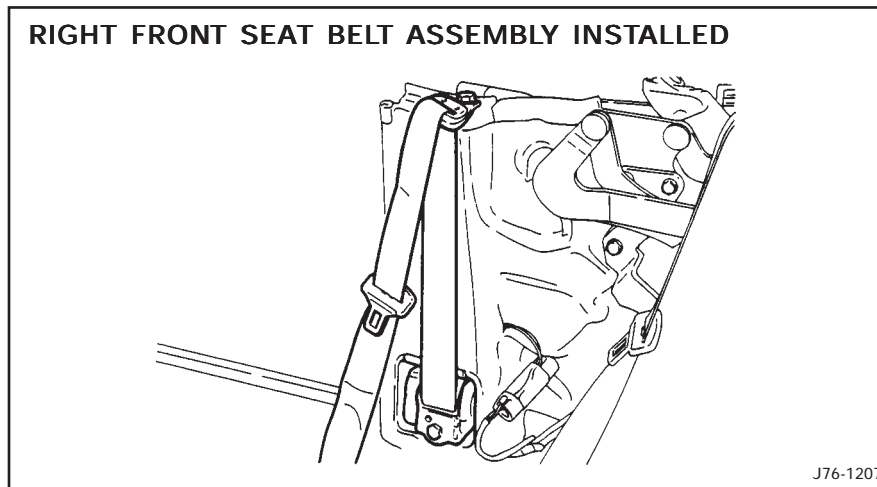

ILLUSTRATION 3

13. Install the new seat belt retractor unit and torque the bolt to 22.1 - 29.5 lb ft (30 - 40 Nm).
14. Position the seat belt through the trim panel opening and over the lower securing rail (Illustration 3). Torque the securing bolt to 22.1 - 29.5 lb ft (30 - 40 Nm).
15. Reposition the carpet.
16. Reconnect the speaker and the interior lamp.
17. Reinstall the rear trim panel.
18. Install the sill tread plate.
19. Repeat the procedure for the opposite side seat belt assembly.
20. Install the rear seat squab.
21. Pass the seat belt buckles through the rear seat cushion and install the cushion.
22. Turn the ignition to position II and raise the convertible top.
23. Close the convertible top latches.
24. Return the front seats to their original positions.

PARTS INFORMATION:

<u>PART NO.</u>		<u>DESCRIPTION</u>	<u>QTY.</u>
HHE 7004AA	/AEE - Doeskin /AEM - Magnolia /AFW - Barley /HEZ - Parchment /LDY - Saville Grey /LEG - Warm Charcoal /AGD - Oatmeal /LFJ - Nimbus Grey	Right side Seat Belt Assembly	1
HHE 7005AA	/AEE - Doeskin /AEM - Magnolia /AFW - Barley /HEZ - Parchment /LDY - Saville Grey /LEG - Warm Charcoal /AGD - Oatmeal /LFJ - Nimbus Grey	Left side Seat Belt Assembly	1
HHE 7155AA		Edge finisher	2

WARRANTY INFORMATION:

<u>FAULT</u>	<u>R.O.</u>	<u>DESCRIPTION</u>	<u>TIME</u>
<u>CODE</u>	<u>NUMBER</u>		<u>ALLOWANCE</u>
TG BC VH	76.92.82	Front seatbelt - vehicle set- replace/modify	0.50 hrs.