

Creak From Seat Riser Mechanism –  
Front Seat Frame

MODEL 1997-99 MY  
XK8 Range

VIN 001001-031345

Remove and destroy Bulletin 910-07, dated 3/99.  
Replace with this Bulletin.  
Revisions are marked with a bar and in **bold text**.

**ISSUE:**

Some XK8 vehicles within the above VIN range may experience a ‘creak’ from a front seat which may be caused by end-float of the rear riser bar of the seat riser mechanism. This bulletin provides a procedure to insert spacers at each end of the rear riser bar.

From VIN 031346 an O-ring has been installed in the same location to minimize end-float of the riser bar.

**ACTION:**

In case of a customer complaint **only**, on an XK8 vehicle within the above VIN range, modify 2 spring clips, Part No. AGU 2722, and install them in the seat riser mechanism as described below.

1. Flatten the curved portion of each of 2 spring clips, by inserting the curved portion of the clip between the open jaws of the vise and then closing the vise firmly. (A, Illustration 1). Note that the small ‘tab’ on the clip, at right angles to the curved portion, should remain above the

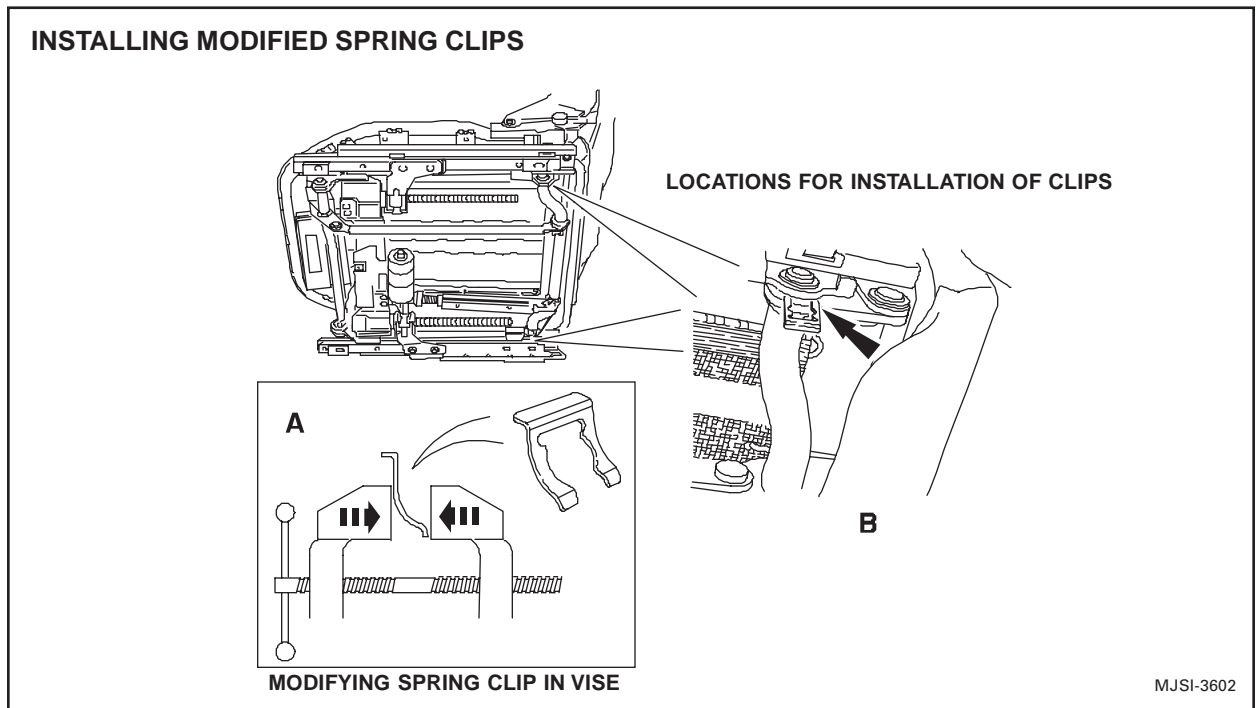

ILLUSTRATION 1

vise jaws during the above procedure, so that the right angle bend is not affected.

2. With the ignition ON, move the seat rearwards until the two front retaining bolts of the seat runners are accessible. Remove the two bolts.
4. Move the seat forwards to allow removal of the two rear retaining bolts. Switch the ignition OFF.
5. Disconnect the battery negative lead.
6. Move the seat as needed to disconnect the multiplug. Remove the seat and place it on a clean workbench so that there is easy access to the underside.
7. Insert the modified clips in the gaps at the two locations shown as B in Illustration 1. Use a small hammer to tap each clip home until its cutout fully engages with the seat riser bar.
8. Place the seat in the vehicle and reconnect the harness multiplug.
9. Reconnect the battery negative lead.
10. Reinstall the two rear retaining bolts and torque to 22-28 Nm (16-21 lb. ft.). Switch the ignition ON.
11. Move the seat rearwards and install the two front retaining bolts. Torque to 22-28 Nm (16-21 lb. ft.).
12. Restore the seat travel to its original location.
13. Reset the clock. Switch the ignition OFF.

### Parts Information:

<u>DESCRIPTION</u>	<u>PART NUMBER</u>	<u>QTY/SEAT</u>
Spring Clip	AGU 2722	2

### Warranty Information:

<u>FAULT CODE</u>	<u>R.O. NUMBER</u>	<u>DESCRIPTION</u>	<u>TIME ALLOWANCE</u>
SG ** 07	76.93.67	Install spring clips on 1 front seat	0.35 hrs.
	<b>76.93.68</b>	Install spring clips on both front seats	0.60 hrs.

\*\* BC Driver's seat  
DC Passenger seat