

New Special Tool –
Quick-fit Connection Release Tool JD 203

MODEL 1995 MY-ON
XJ12 Sedan

VIN
720001-ON

ISSUE:

A release tool for disconnecting quick-fit connectors has been issued. JD 203 consists of two hinged plastic sleeves for releasing the fuel lines from the quick-fit connectors. Connectors are of two different sizes.

ACTION:

WARNING: Observe all safety precautions when working around fuel.

1. Place the tool around the fuel line as shown in Illustration 1.
2. Push the tool fully into the connector to release the fuel line retainer.
3. Remove the fuel line with the tool in place.

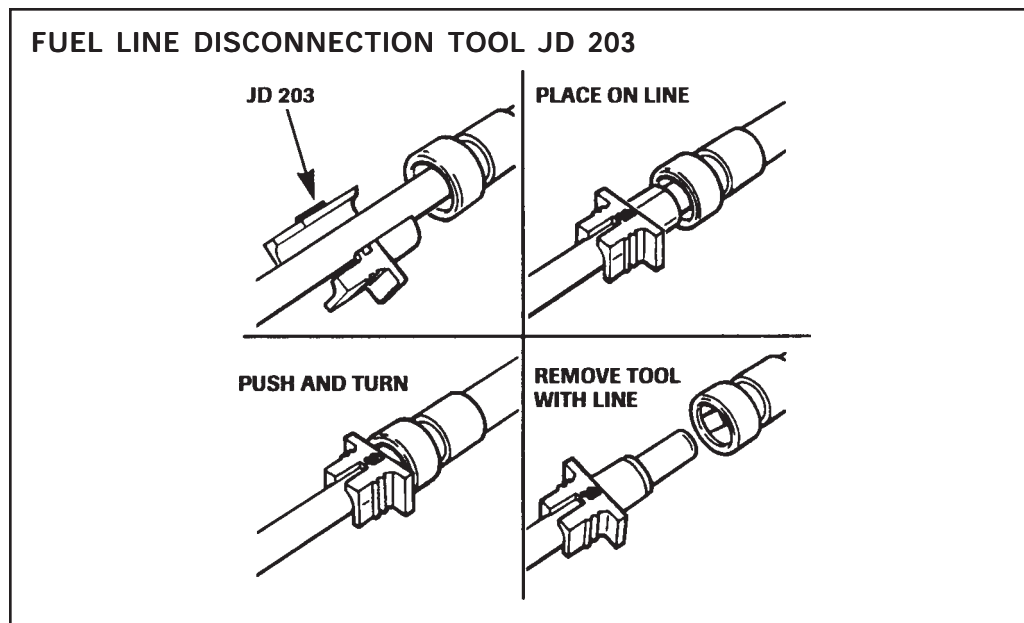

ILLUSTRATION 1

NOTE: The tool is required only to disconnect the fuel lines. To connect, slide the fuel line fully into the connector assuring that it is securely engaged in the retainer.